



If you are not entirely satisfied with this product please return it to the store where it was purchased and we will be pleased to replace or refund it. This does not affect your statutory rights.



**PRODUCED IN CHINA FOR:**

ALDI STORES LTD. PO BOX 26, ATHERSTONE  
WARWICKSHIRE, CV9 2SH.

---

ALDI STORES (IRELAND) LTD.  
PO BOX 726, NAAS, CO. KILDARE.  
Visit us at [www.aldi.com](http://www.aldi.com)



# User Manual

**GARDENLINE<sup>®</sup>**

## **MODULAR RAISED BED**



# Contents

<b>Overview</b> .....	<b>3</b>
<b>Package contents/parts</b> .....	<b>3</b>
<b>Assembly diagram</b> .....	<b>4</b>
<b>General information</b> .....	<b>5</b>
Reading and storing the user manual .....	5
Explanation of symbols .....	5
<b>Safety</b> .....	<b>6</b>
Proper use .....	6
Safety instructions.....	7
<b>First use</b> .....	<b>8</b>
Checking raised bed and package contents.....	8
<b>Assembly</b> .....	<b>9</b>
<b>Use</b> .....	<b>9</b>
<b>Maintenance and care</b> .....	<b>10</b>
<b>Storage</b> .....	<b>11</b>
<b>Technical data</b> .....	<b>11</b>
<b>Disposal</b> .....	<b>11</b>
Disposal of packaging.....	11
Disposal of the raised bed.....	11

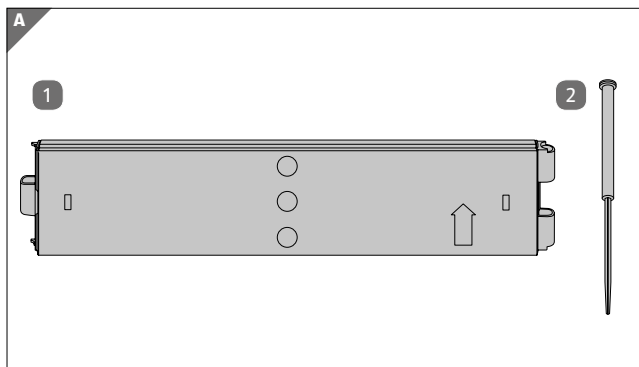

## Package contents/parts

- 1 Side section, 8×
- 2 Connectors, 8×

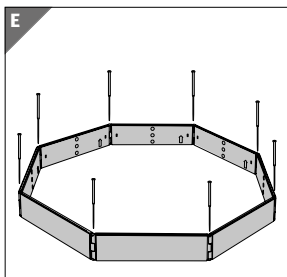
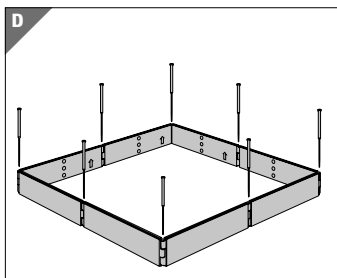
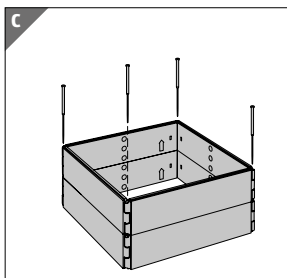
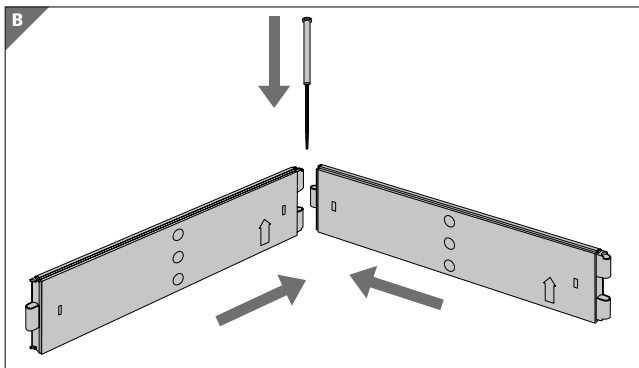

# General information

## Reading and storing the user manual



These operating instructions belong to this modular raised bed (hereinafter referred to as "raised bed").

They contain important information on the initial setup and handling.

Carefully read the operating instructions, especially the safety instructions, before using the raised bed. Failure to follow these operating instructions may result in serious injuries or damage to the raised bed.

The operating instructions are based on the standards and regulations which are valid within the European Union. Observe country-specific guidelines and laws which are applicable abroad.

Store the operating instructions adequately to enable further use. If you pass on the raised bed to a third party, be sure to include these operating instructions.

## Explanation of symbols

The following symbols and signal words are used in this user manual, on the raised bed or on the packaging.



**WARNING!**

This signal symbol/word designates a hazard with a high degree of risk, which will result in death or severe injury if not avoided.



**CAUTION!**

This signal symbol/word designates a hazard with moderate risk, which may result in death or severe injury if not avoided.

**NOTICE**

This signal symbol/word warns of possible damage to property.

## **Safety**

### **Proper use**

The raised bed is exclusively designed as a plant container. It is intended exclusively for private use and is not suitable for commercial use. The raised bed is suitable for use all year round. The raised bed is not a toy for children.

Only use the raised bed as described in these operating instructions. Any other use is considered improper and can lead to material damage.

The manufacturer or retailer shall not accept any liability for damages caused by improper or incorrect use.

---

## Safety instructions

**WARNING!**

### **Danger of suffocation!**

If children play with the packaging film, they can get caught up in it, put it over their head or swallow it, and thus suffocate.

- Do not let children play with the packaging film. Children can get caught up in it and suffocate while playing.

**WARNING!**

### **Fire hazard!**

The plastic parts are made of combustible materials. If they are too close to strong heat sources or open fire, they can burn.

- All parts must be kept away from strong heat sources or open fire.





## **WARNING!**

### **Risk of injury!**

- The raised bed is not suitable as a standing surface, as a seat or as a climbing aid.

## **NOTICE**

### **Risk of damage!**

Improper handling of the raised bed can result in damage to the raised bed.

- Do not attach any objects to the raised bed.

## **First use**

### **Checking raised bed and package contents**

## **NOTICE**

### **Risk of damage!**

If you open the packaging carelessly with

a sharp knife or other sharp object, the raised bed can quickly be damaged.

- Be very careful when opening.
1. Remove the individual parts of the raised bed from their packaging.
  2. Check whether the delivery is complete (see **Fig. A**).
  3. Check whether the individual parts are damaged. Contact the manufacturer if this is the case.

## Assembly

Select your desired setup shape (see **Fig. C**, **Fig. D**, **Fig. E**) and set up the raised bed in a suitable location in the garden.

- Join the side sections **1** with the connectors by inserting the connectors **2** into the recesses on the side sections (see **Fig. B**). During assembly, make sure that the arrows on the side sections are pointing upwards.
- For the flat setup (see **Fig. D** and **Fig. E**), you can slide the connectors in far enough that the raised bed is anchored in the soil.

## Use

Fill the assembled raised bed with soil and plant it with flowers, vegetable plants, herbs, berries etc.

## Maintenance and care

### NOTICE

#### **Risk of damage!**

Improper handling of the raised bed can result in damage to the raised bed.

- Do not use aggressive cleaning agents, brushes with metal or nylon bristles, or sharp or metallic cleaning objects like knives, hard spatulas and the like. These can damage the surfaces.
- Only clean the raised bed with water.
- Wipe the raised bed with a slightly moistened cloth.
- Let the raised bed dry completely afterwards.
- Check the raised bed regularly for cracks, damage and wear.

---

## Storage

- Always store the raised bed in a dry place.

## Technical data

Model:	FLX-MHBb-01
Weight:	2.7 kg (set)
Size side section:	ca. 57.5 × 2 × 13.7 cm
Size connectors:	ca. Ø 1.8 × 24.5 cm
Material:	100% recyclable polypropylene
Item Number:	803861

## Disposal



### Disposal of packaging

Dispose of the packaging sorted by type. Dispose of cardboard and other related substances in the waste paper collection, and foils in the recyclable waste collection.

### Disposal of the raised bed

- Dispose of the raised bed in accordance with the laws and regulations applicable in your country.